

MT398-02 MASSAGE CHAIR

OPERATION INSTRUCTIONS

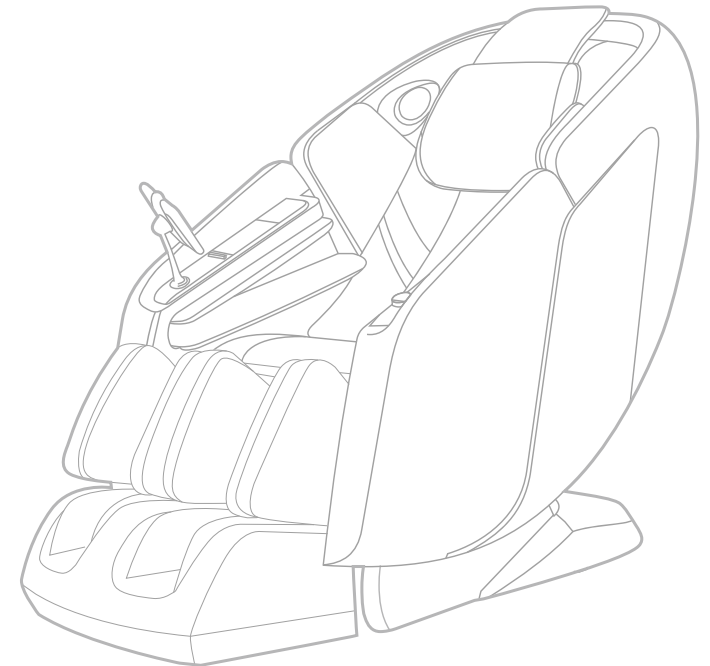

(Please Read the Manual Carefully Before Installing and Using the Product)

Foreword

Thank you for purchasing this product. Please read this user manual carefully before using to ensure proper operation.

Contents

Installation Instructions	02-04
Structure	05-06
Quick Button Instructions.....	07
Controller Instructions	08-11
How to Use	12
AI Voice control	13
Important Safety Instructions	14-15
Abnormalities and handling methods	15
Product Maintenance	16
Hazardous Substances Identification Table	17
FCC Statement	18-19
Product Specifications	20

Installation Instructions

(1) Unpack the carton and take all massage chair units out of the carton.

lift the carton vertically

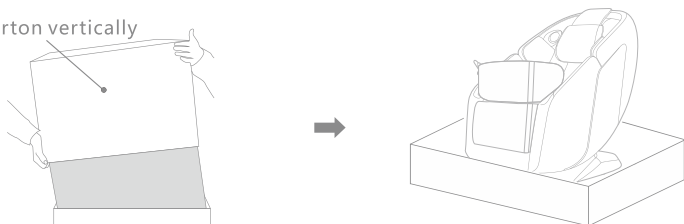

- 1.1. Remove secure straps and lift the carton vertically.
- 2.2. Take all accessories out of the cartons.

(2) Calf installation process

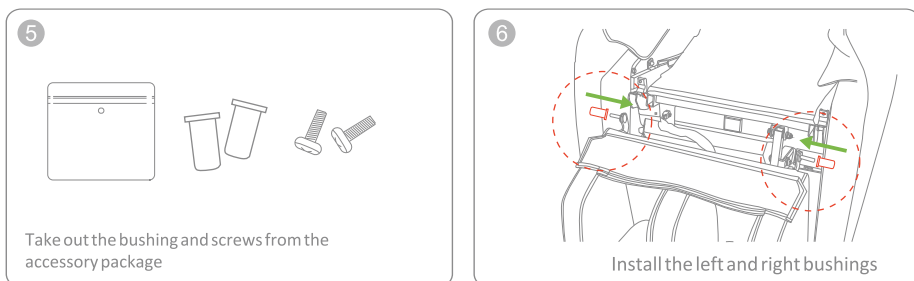
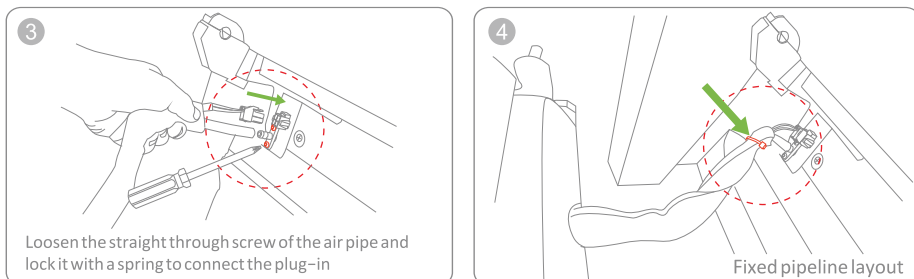
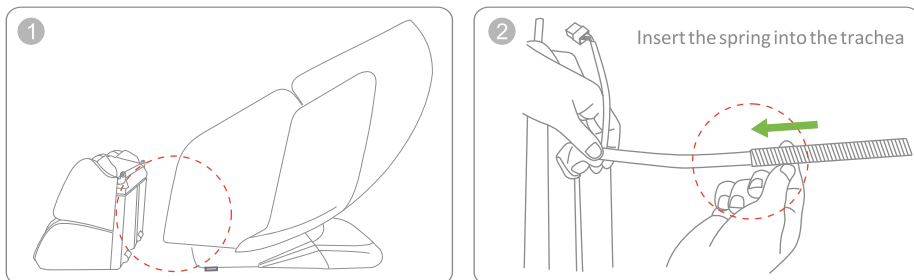

Installation Instructions

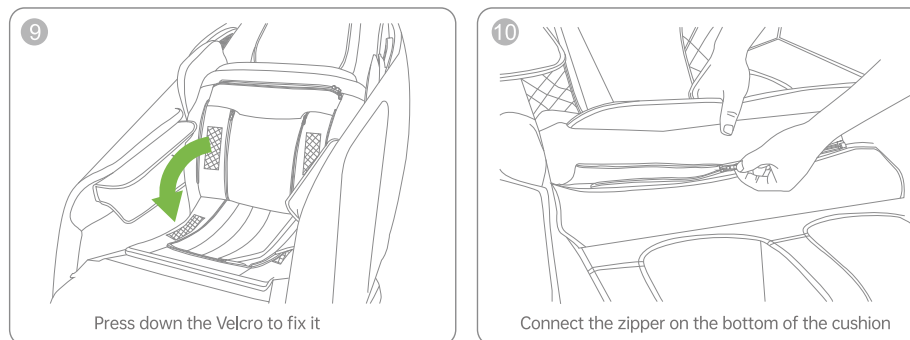
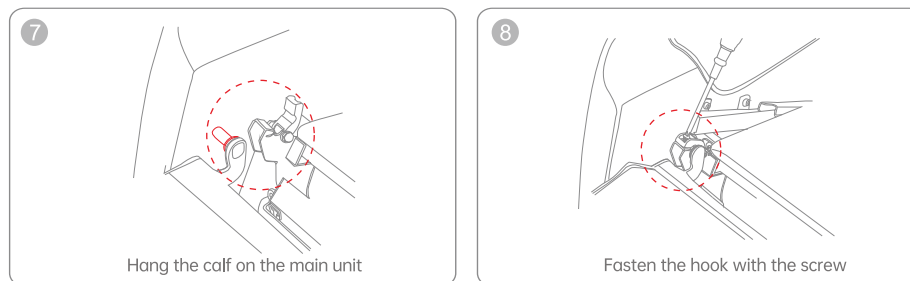

(3) Install tablet holder

Insert the lower end of tablet holder into the socket and turn clockwise to secure the holder into place. Use an allen key to tighten the remote control bracket.

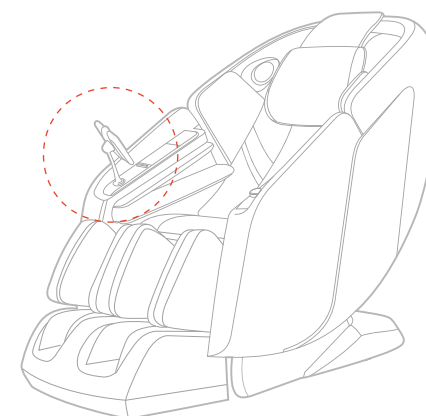
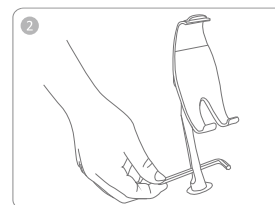
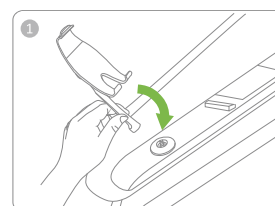

Installation Instructions

(4) Placing the massage chair

- *Carry the massage chair out of the carton and place at a desired location.
- *Do not put this product near heat source, open flame or in direct sunlight.
- *This may cause fading or damage.
- *The bottom of the massage chair may scratch the floor, we recommend placing a piece of carpet or soft mat underneath it to avoid damaging the floor.
- *Please allocate clearance to the front and back (a minimum 25-centimeter clearance behind the backrest) of the product;
- *Do not put the massage chair in high moisture environment or on uneven unlevelled floor.
- *Keep it 1 meter away from the TV, radio or other audio/video appliance to avoid signal interference.

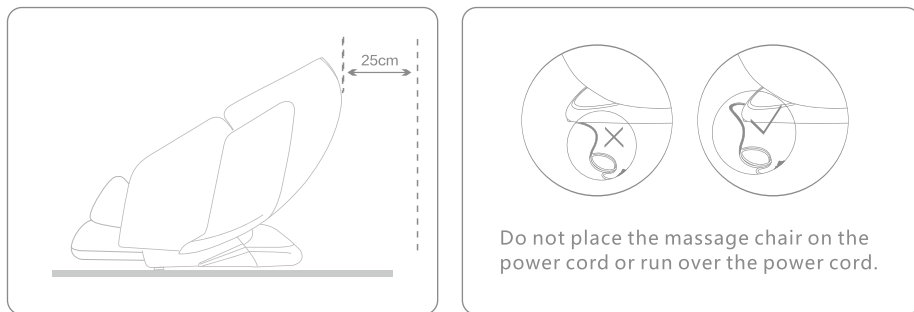

(5) Connect to power

Plug the power cord into the chair and connect to the power outlet, turn on the main power switch, you are set to go.

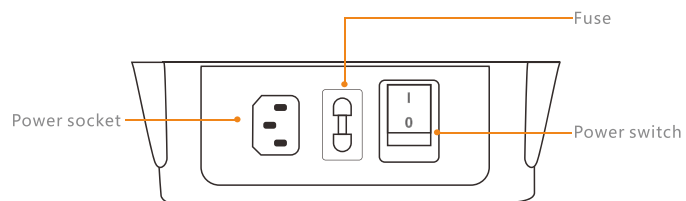

Structure

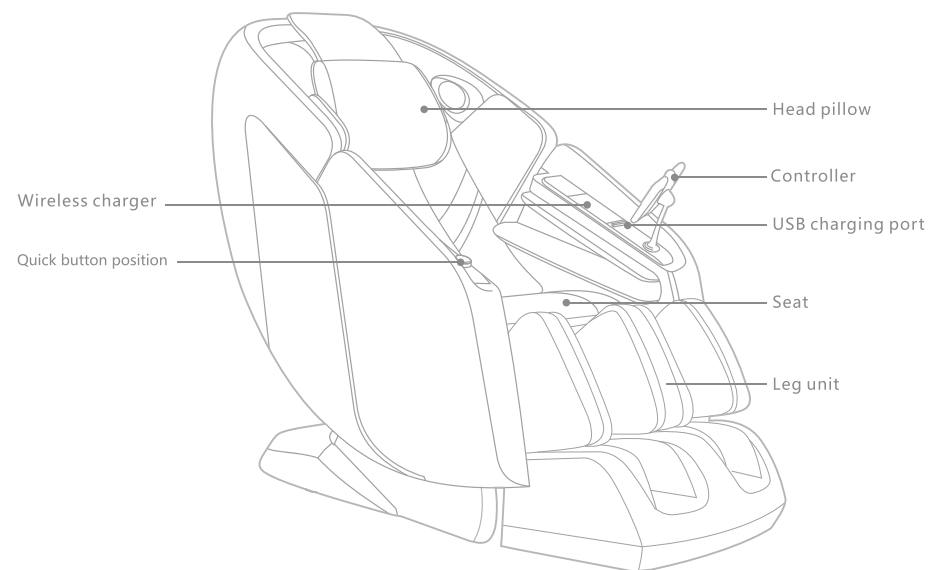

Moving the Massage Chair

1. Push down on the backrest and tilt the chair about 30° (see left figure).
2. Roll the chair on its casters to the desired location.

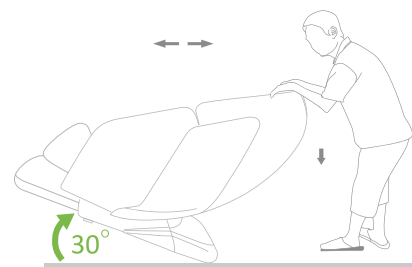

WARNING

- *Do not move the chair when there is user inside.
- *Moving the chair may scratch the floor, we recommend placing a piece of carpet or soft mat underneath it.
- *Please hold the backrest firmly when moving the massage chair to avoid falling.
- *Make sure the footrest is fully retracted when moving the massage chair to avoid damage.

Structure

Back of massage chair

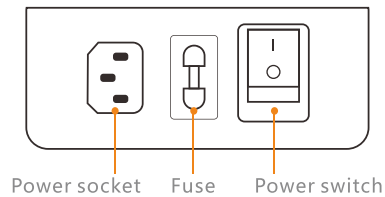
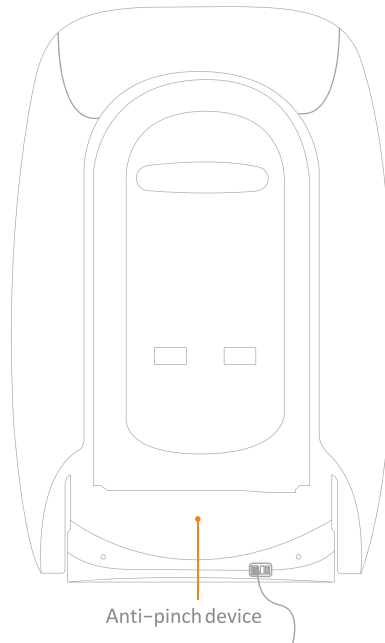



Anti pinch device : The massage chair will stop reclining automatically when any foreign objects[such as pet or children]are sensed, it will continue to recline when foreign object is removed.

Quick Button Instructions

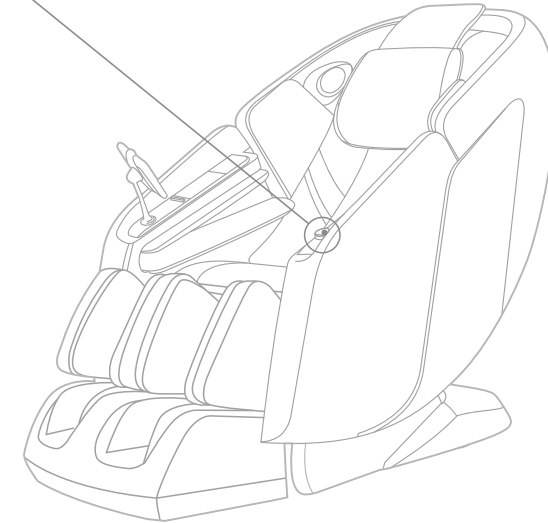
Quick button position



Quick Button Instructions





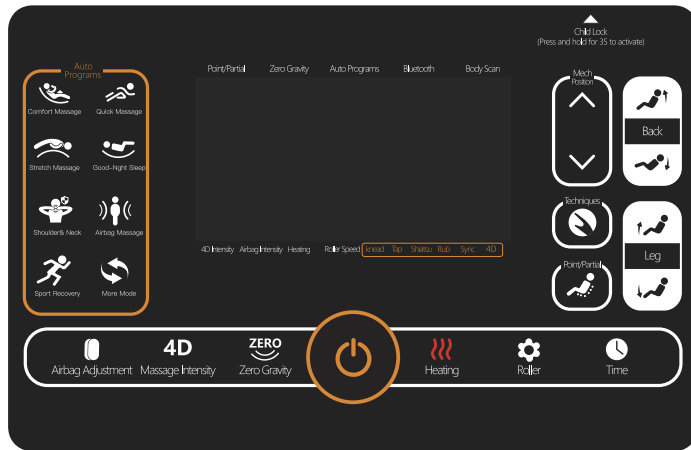

-  • Press and hold the power button for 3 seconds to turn on/off massage chair;
-  • Short press this button to toggle among 8 pre-set Auto massage programs namely: Boss Massage, Lady Massage, Sweet Dreams, Neck & Shoulder, Chair Yoga, Deep Release, Thai Massage and Chinese Massage;
-  • Rotary switch : rotate this switch to raise/recline the backrest : rotate clockwise to raise backrest, rotate counterclockwise to recline backrest.

Controller Instructions











Button Distribution Of Control Panel













Controller Instructions

- 
Child Lock
 When connected to power, press and hold this button for 3 seconds to lock/unlock the controller.
- 
Power Button
 Short press to power on, short press to pause/resume massage during operation, and long press to power off.
- 
Comfort Massage
 Moderate massage strength, specially designed for female users, providing a massage program that shapes a graceful and light figure without burden.
- 
Quick Massage
 Quick and precise combination massage, saving time and relaxing the body.
- 
Stretch Massage
 Full-body stretching to cater to users who need to stretch their muscles, relieving fatigue and restoring body vitality and flexibility.
- 
Good-night Sleep
 Gentle massage with coordinated , alleviating fatigue and promoting a restful sleep, easing tension for a serene slumber.





Controller Instructions

- 
Shoulder & Neck Massage
 Unique massage techniques targeting the shoulders and neck, effectively relieving shoulder and neck soreness and improving fatigue.
- 
Airbag Massage
 Gentle and sequential compression by airbags, progressively providing deep relaxation and decompression throughout the entire body.
- 
Sport Recovery
 Relieves post-exercise muscle soreness, discomfort in the neck, shoulders, back, waist, and legs, and helps muscles recover after exercise.
- 
More Mode
 - 
Stress Relieving: Gentle massage strength. Comforts the whole body, promotes blood circulation, relaxes the body and mind, effectively relieves various discomforts caused by long and continuous work, and eliminates overall fatigue.
 - 
Thai Massage: Simulates the techniques used in Thai massage, with a stronger intensity, providing a relaxing experience for the entire body.
 - 
Waist & Hip Massage: Unique massage techniques targeting the waist and hips, effectively relieving waist and hip soreness and improving lower back fatigue.
 - 
Spine Care: Unique massage techniques targeting the spine, effectively relieving spinal soreness and improving spine fatigue.
 - 
Energy: Gentle and comfortable massage to relieve physical fatigue, relax the body and mind, and boost vitality.
 - 
Shiatsu Massage: Utilizing kneading and acupressure massage techniques, as if gentle hands are providing a deep massage to soothe weariness and tension.
 - 
Office Regimen: Gradually applies varying levels of pressure to the entire body, effectively alleviating muscle soreness and promoting the recovery from fatigue.
 - 
TV Mode: Soft massage suitable for older users, effectively rejuvenating the body and improving blood circulation.

Controller Instructions

-  Press and hold to raise the backrest, release the button to stop.
-  Press and hold to lower the backrest, release the button to stop.
-  Press and hold to raise the footrest unit, release the button to stop.
-  Press and hold to lower the footrest, release the button to stop.
-  Press and hold Up button to move the massage rollers up, release the button to stop.
-  Press and hold Down button to move the massage rollers down, release the button to stop.
-  Press this button to switch to manual massage mode, press again to toggle manual massage techniques.
-  Under manual mode, Press this button to switch between fixed point-partial-full-body-upper body-lower body massage. You can press and hold Up/Down button to adjust the rollers to the desired position.
-  In automatic mode, the airbag system offers five levels of intensity adjustment and the option to disable the airbag function. The default airbag intensity is set to the third level.
In manual mode, the airbag adjustment button can sequentially switch the airbag positions in the order of shoulder - arm - hip - leg - upper body - lower body - full body - airbag off.
-  The intensity of the 4D massage can be adjusted into five levels of strength, with the default intensity set at the third level.

Controller Instructions

-  Zero Gravity Adjustment Button: There are three automatic reclining angles to choose from, suitable for individual preferences.
-  Press this button to navigate among: level 3,2,1 heating, or Off (deactivate heating function).
Long press this key for 3 seconds to turn on and off the armrest LED light.
-  Press this button to navigate among: level 3,2,1 foot roller speed, or Off (deactivate foot roller function).
Press and hold this button for 3 seconds to deactivate Bluetooth function (default setting: off/on).
-  Press this button to set massage time.
You may toggle among 10-15-20-25-30 minutes settings (20 minutes is the default setting).
Long press this key for 3 seconds to switch the voice control.

How to Use

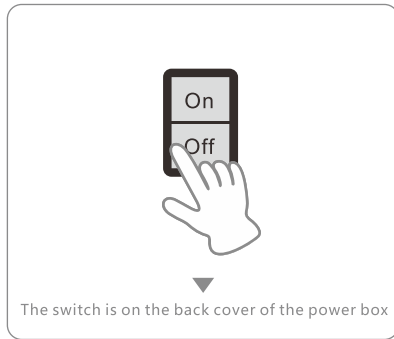

- *Press the power switch at the armrest to stop all massage motions.
- *When not in use for a long period of time, be sure to turn off the power switch.
- *Disconnect the power cord from the electrical outlet.
- *Do not drag the power cord to avoid damage to the cord, leading to fire or electric shock.

Bluetooth Connection

- * When the massage chair is on, the Bluetooth is on as the default setting, you may turn on Bluetooth on your mobile device, choose "MT398" to pair.
- * You can enjoy music when Bluetooth is connected.
- ★ Press and hold the "Roller" button on the control panel for 3 seconds to deactivate Bluetooth function (default setting: off/on).



CAUTION

- *Do not get into the massage chair when the footrest is lifted.
- *A sudden excessive load pressed on the backrest or footrest may cause damage to the product or injury to the user.
- *Before getting in the chair, please make sure the backrest is restored to upright position, you may recline the chair to desired angles after sitting in the chair.
- *Do not put foot, fingers or any other objects in the openings of the chair.
- *Make sure there are no children, pets or other obstacles around before adjusting the backrest or footrest angle.

AI Voice Control

AI voice control

- ★ Long press the "Time" button on the control panel key for 3 seconds to switch the voice control.
 - ▶ Supported Language: English
 - ▶ To wake up the "Voice Module," users should speak "Hi Alfi" into the microphone. When the massage chair is in the shutdown mode, saying any of the following commands within 10 seconds will directly activate the massage.
 - ▶ Voice Wake-up Commands. Turn voice on or off in Setting

Note: When using the voice control function, the speech speed should not be too fast, and the voice commands should be issued according to the voice control entries. After each successful use of the voice-activated entry, it is recommended to give out the voice command after 1-2 seconds.

Voice Wake-up Commands	AI Response
Hi Alfi	I'm here
Massage on	OK, Massage on
Massage stop	OK, Massage stop
Comfort Massage	OK, Comfort Massage
Quick Massage	OK, Quick Massage
Stretch Massage	OK, Stretch Massage
Good-night Sleep	OK, Good-night Sleep
Shoulder and neck Massage	OK, Shoulder and Neck Massage
Air massage on	OK, Air massage on
Air massage stop	OK, Air massage stop
Up the seat position	OK, Up the seat position
Down the seat position	OK, Down the seat position
Change the other mode	OK, Change the other mode
Go little down	OK, Go little down
Go little up	OK, Go little up
Turn on the heat	OK, Turn on the heat
Turn off the heat	OK, Turn off the heat

Important Safety Instructions



warning

Before using, please read all instructions. Use the original power cord, and follow the specifications for power connection and switch operation to prevent safety hazards. When using electronic products, follow basic safety precautions to check for the risks of electric shock, burns, fire, or personal injury, including the following:

- Be sure to use an outlet that matches the plug.
- Make sure that the plug is fully inserted into the socket to reduce the risk of short circuit or fire.
- After use or before cleaning, be sure to unplug the plug in time.
- Do not use this product at high temperatures.
- Do not store or use this product outdoors or in direct sunlight.
- If there is a sudden power failure during use, please set the switch to the "0" position immediately, and unplug the plug to avoid damage to the product when a call comes in.
- Do not operate the massage chair if the cord is wet or damaged.
- Do not insert or unplug the plug with wet hands to avoid accidents.
- When a child, handicapped, or handicapped person is near or using a massage chair, someone must be present to look after him.
- Only use this product for the purposes described in this manual.
- Do not use accessories not provided by Momoda.
- Do not stand, sit or jump on the calf rest. So as not to cause damage.
- Please do not try to sit on the armrest or backrest, so as not to tip the massage chair over and cause an accident.
- Do not go to sleep during the massage.
- Please keep the massage chair clean and avoid inserting other objects into the gaps of the massage chair
- Do not move the massage chair directly by pulling the power cord.
- Before each use, check whether there are abnormal cracks in the flannelette of the backrest of the massage chair.
- This product is designed for home use only.
- When you are not sure whether you can use the massage chair, please consult your doctor.
- In order to avoid discomfort or injury caused by using this massage chair, the following people should consult a physician before using this product; Those receiving treatment, those with back disease, those with abnormal or distorted cervical spine.
- If you feel pain during use, please stop using it immediately. If it is damaged during use, please seek medical attention immediately.
- Do not massage red, swollen or inflamed skin.
- This product only provides comfortable massage enjoyment for the family. It is not a professional massage medical device, so it cannot replace professional treatment.
- It is recommended to use the massage chair for 30 minutes a day, and massage the same part should not exceed 15 minutes, otherwise excessive massage will result in counterproductive effects, and long-term use will cause the massage chair to overheat and shorten the service life of the product.
- Do not use this product in an environment where gas or oxygen is injected.
- This product is not suitable for children under 12 years of age.

Important Safety Instructions



warning

- Those who are not allowed to use this product: those who are physically, emotionally, or mentally defective, or who lack experience and knowledge. Unless they are supervised or instructed by the person responsible for their safety regarding the use of the product.
- Children should be supervised to ensure that they do not play with the massage chair.
- If the power cord is damaged, it must be replaced with a special cord or a special component purchased from its manufacturer or maintenance department.
- The surface of the appliance heats up, so people who are not sensitive to heat must pay attention to it.
- Do not use this machine under a voltage that does not meet the standards of this machine.
- This product must use a grounded three-core power socket, and there should be a reliable and good grounding device.
- Damaged leather or cloth covers should be replaced in time. Do not use this machine to avoid personal injury.
- Do not allow water or moisture to enter the hand controller to avoid control failure.

10 Abnormalities and handling methods

Possible situation	Approach
The sound made during operation	The sound produced by the structural design will not affect the machine. Check if the power head is plugged in or is powered on. Check whether the power switch of the massage chair is in the "I" position.
The power is plugged in, but the massage chair cannot be operated.	Check whether the power cord is damaged. Check that the fuse is damaged and replace the fuse. Check whether the manual control line is inserted well and screwed
The backrest cannot be raised and lowered freely.	Check whether there are foreign objects stuck in the backrest and lower legs. Check whether the connecting wire is loose.
During use, the controller can be operated, but the massage chair cannot be operated.	After a long period of operation, if the temperature of the machine is too high, the massage chair will be automatically in the temperature protection state, please turn off the power and use it for 30 to 50 minutes to let the internal heat dissipation of the machine.
During use, the controller cannot be operated, and the massage chair also stops operating	After the automatic timing function is activated. If the set time is up, please press the button again to control it.

If an abnormal situation occurs, in order to prevent accidents, please stop using it and unplug the power cord.

If the following solutions are still invalid, please contact the after-sales service center.

Product Maintenance

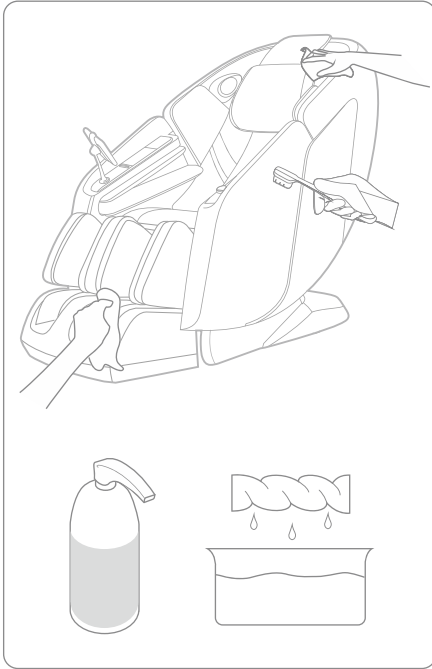

Clean

Do not use steel wool, abrasive cleaners or corrosive liquids (such as gasoline or acetone) to clean the product.

- ❶ Unplug the plug from the power socket.
- ❷ Clean the massage chair, remote control and power cord with a dry cloth.
- ❸ Do not use a damp cloth or detergent.

Storage

- ❶ Unplug the plug from the power socket.
- ❷ Store this product in a cool and dry place away from sunlight.
- ❸ Do not place heavy objects on the product.

If the leather case is damaged or mechanical failure, please stop using this product and inquire from the authorized after-sales service center or customer service center in your country (region).

If you do not use it for a long time, please unplug the power cord!

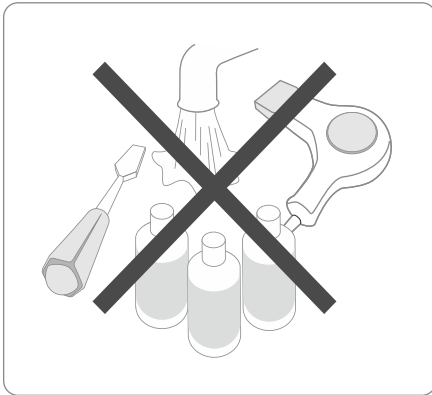

Name and content identification table of hazardous substances in this product

Name	Harmful Materials					
	(Pb)	(Hg)	(Cd)	(Cr)	(PBB)	(PBDE)
Case	○	○	○	○	○	○
Circuit Board※	○	○	○	○	○	○
Metal	○	○	○	○	○	○
Rubber	○	○	○	○	○	○
Power Cable	×	○	○	○	○	○
Internal Signal Connection Line	○	○	○	○	○	○
Leather	○	○	○	○	○	○

This form is compiled in accordance with the provisions of SJ/T 11364

※ Circuit board components include parts made up of printed circuit board machines, such as resistors, capacitors, integrated circuits, connectors, etc.

○ Indicates that the content of the hazardous substance in all homogeneous materials of the part is below the limit requirement specified in GB/T26572.

× Indicates that the content of the hazardous substance in at least one of the homogeneous materials of the part exceeds the limit requirement specified in GB/T 26572.

Environmental protection use period description

This electrical product is used under the conditions described in the manual, and the harmful substances or elements contained in this product will not leak out, and will not cause pollution to the environment or cause serious damage to people and property for a period of 10 years.



Our company reserves the right to improve the product and the manual. If there is any change, we will not notify you. The appearance of the product is subject to the actual product; this booklet has been carefully checked, but it does not rule out the possibility of printing errors or misunderstandings in the content. Please forgive me.

FCC Statement

FCC Statement:

This device complies with part 15 of the FCC Rules. Operation is subject to the following two conditions: (1) This device may not cause harmful interference, and (2) this device must accept any interference received, including interference that may cause undesired operation.

This equipment has been tested and found to comply with the limits for a Class B digital device, pursuant to part 15 of the FCC Rules. These limits are designed to provide reasonable protection against harmful interference in a residential installation. This equipment generates, uses and can radiate radio frequency energy and, if not installed and used in accordance with the instructions, may cause harmful interference to radio communications. However, there is no guarantee that interference will not occur in a particular installation. If this equipment does cause harmful interference to radio or television reception, which can be determined by turning the equipment off and on, the user is encouraged to try to correct the interference by one or more of the following measures:

- Reorient or relocate the receiving antenna.
- Increase the separation between the equipment and receiver.
- Connect the equipment into an outlet on a circuit different from that to which the receiver is connected.
- Consult the dealer or an experienced radio/TV technician for help.

Caution: Any changes or modifications not expressly approved by the party responsible for compliance could void the user's authority to operate the equipment.

This equipment complies with FCC radiation exposure limits set forth for an uncontrolled environment. This transmitter must not be co-located or operating in conjunction with any other antenna or transmitter.

This equipment should be installed and operated with minimum distance 20cm between the radiator&your body.

IC Statement:

This device complies with Industry Canada' s licence-exempt RSS standard(s). Operation is subject to the following two conditions:

- (1) This device may not cause interference; and
- (2) This device must accept any interference, including interference that may cause undesired operation of the device.

Le présent appareil est conforme aux CNR d'Industrie Canada applicables aux appareils radio exempts de licence. L'exploitation est autorisée aux deux conditions suivantes : (1) l'appareil ne doit pas produire de brouillage, et (2) l'utilisateur de l'appareil doit accepter tout brouillage radioélectrique subi, même si le brouillage est susceptible d'en compromettre le fonctionnement.

FCC Statement

FCC Statement:

This equipment has been tested and found to comply with the limits for a Class B digital device, pursuant to Part 15 of the FCC Rules. These limits are designed to provide reasonable protection against harmful interference in a residential installation. This equipment generates uses and can radiate radio frequency energy and, if not installed and used in accordance with the instructions, may cause harmful interference to radio communications. However, there is no guarantee that interference will not occur in a particular installation. If this equipment does cause harmful interference to radio or television reception, which can be determined by turning the equipment off and on, the user is encouraged to try to correct the interference by one or more of the following measures:

- Reorient or relocate the receiving antenna.
- Increase the separation between the equipment and receiver.
- Connect the equipment into an outlet on a circuit different from that to which the receiver is connected.
- Consult the dealer or an experienced radio/TV technician for help.

Caution: Any changes or modifications not expressly approved by the party responsible for compliance could void the user's authority to operate the equipment.

This equipment complies with FCC radiation exposure limits set forth for an uncontrolled environment. This transmitter must not be co-located or operating in conjunction with any other antenna or transmitter.

IC Radiation Exposure Statement:

This equipment complies with Canada radiation exposure limits set forth for uncontrolled environments. This transmitter must not be co-located or operating in conjunction with any other antenna or transmitter.

Déclaration d' IC sur l' exposition aux radiations:

Cet équipement est conforme aux limites d' exposition aux radiations définies par le Canada pour des environnements non contrôlés. Cet émetteur ne doit pas être installé au même endroit ni utilisé avec une autre antenne ou un autre émetteur.

RF exposure warning:

This equipment complies with radiation exposure limits set forth for an uncontrolled environment. This equipment should be installed and operated with minimum distance 20cm between the radiator and your body.

L' environnement du millipascal incontrôlés, leurs conditions normales d' utilisation de maintenir, au moins 20cm avec les utilisateurs.

Product Specifications

Items	Manual
Name	MT398 Massage Chair
Configure	02
Rated voltage	AC120V
Rated frequency	60Hz
Rated power	120W
Packing dimension	1340mm(L)x810mm(W)x1245mm(H)
Weight	N.W. 92.5kg G.W. 118.4kg
Made in	China
Safety design	Class I
Default working time	20Minutes
Enforcement standard	GB 4706.1-2005 GB 4706.10-2008
This device contains approved wireless LAN / Bluetooth module with an authorization number of CMIIT ID 2021DP9497	